

ROTARY ENCODER

HTR-W ECONOMICAL & SMALL ROTARY ENCODER

HTR-6B HEAVY DUTY ROTARY ENCODER

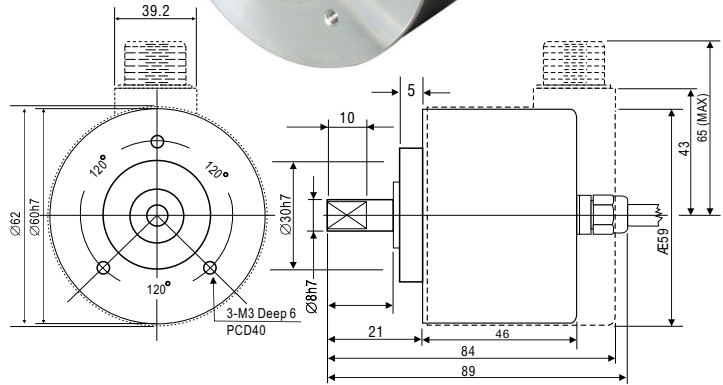
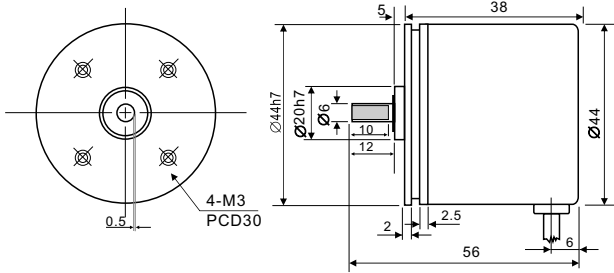

HTR-W

HTR-6B

■ SPECIFICATION

MODEL NO.	HTR-W	HTR-6B
Detection System	Incremental	
Output Wave	Square Wave (* only with AB phase)	
Pulse Per Revolution	5, 10, 20, 30, 40, 50, 60, 80, 100, 120, 125, 150, 160, 180, 200, 250, 300, 360, 400, 500, 512, 600, 720, 800, 1000, 1024, 1200, 1500, 2000, 2500	2, 5, 10, 20, 30, 40, 50, 60, 80, 100, 120, 125, 150, 160, 180, 200, 250, 300, 360, 400, 500, 512, 600, 720, 800, 900, 1000, 1024, 1200, 1500, *1800, 2000, *2048, 2500, *3000, *3600, *4000, *5000
Output Phase	AB phase or ABZ phase	
Electronics	Voltage, Open Collector, Push Pull or Line Driver	
Power Supply	DC 8~26V ; DC 5V fixed	
Current Consumption	≤ 60mA	
Output Capacity	Sync. Current: 20mA, Residual Voltage: 0.5V or less	
Max. Response	10K Hz ~ 100K Hz	
Phase Different	A, B phase different $90^\circ \pm 45^\circ$ (T/4 \pm T/8), Z phase T \pm T/2	
Wave From Rise / Fall	2ms or less	
Shaft Diameter	6mm	8mm
Shaft Loading	(10~400PPR) Axial: 1kg, Radial: 2kg, (over 400PPR) Axial: 0.5kg, Radial: 1kg	(10~1000PPR) Axial: 4kg, Radial: 8kg, (over 1000PPR) Axial: 2kg, Radial: 4kg
Starting Torque (at 25°)	30 gf-cm or less	260 gf-cm or less
Max. Speed	6,000 rpm	6,000rpm
Vibration	10g (10 \pm 1,500 Hz)	
Polarity	Against Reverse Protection (Except Line Driver)	
Shock	20g per 11ms	
cable	$\varnothing 4.5$, 50cm long	$\varnothing 5.4$, 100cm long
Weight	≤200g	≤350g
Operating Temp./Humidity	-10°C ~ 60°C, RH 35%~90% (No condensation)	
Storage Temp.	-20°C ~ 80°C	
Protection	Ip50: Dust proof	Ip64 (standard): Dust & Dripping proof

■ ORDERING INFORMATION

Model No.	Pulse per Revolution	Output Phase	Electronics	Supply Voltage	(For HTR-6B) Connection
HTR-W	500	2			
HTR-W	<i>See the different PPR as above specification</i>	2: AB phase 3: ABZ phase 3H: AB+Z high phase	Blank: Voltage C: Open-Collector PP: Push-Pull *L: Line Driver 5VDC *HL: Line Driver 8~26VDC	Blank: 8~26VDC 5V: 5VDC fixed	Blank Axial Cable *R7 Radial 7 pin *R10 Radial 10pin
HTR-6B					

Encoder & Flexible Coupling

ENCODER



Power Source	5V, 8~24V DC	 Mode A Mode B
Current Consumption	50mA or below	
Response Frequency	30KHz	
Output Impedance	2KΩ (Mode: A)	
Starting Torque	300g.cm or less	
Shaft Loading	Radial: 4kgs, Thrust: 1.5kgs	
Max. R.p.m.	6000r.p.m.	
Output Mode	A: With pull up resistor B: Open Collect	
Output Signal	A & B A.B.Z	

- **Features:** EHG - Shaft \varnothing 6
 EMB - Shaft \varnothing 8
 Collar Mounting

- **Resolution: (P/R)** 10, 20, 25, 30, 40, 50, 60, 90,
 100, 120, 180, 200, 300, 360,
 400, 500

■ **Connection**

Red	Black	White	Green	Yellow	Shield
+	-	A	B	Z	

FLEXIBLE COUPLING

*One-body shape and Zero backlash, High deflection
 Application for Encoder or transfer of low horsepower*

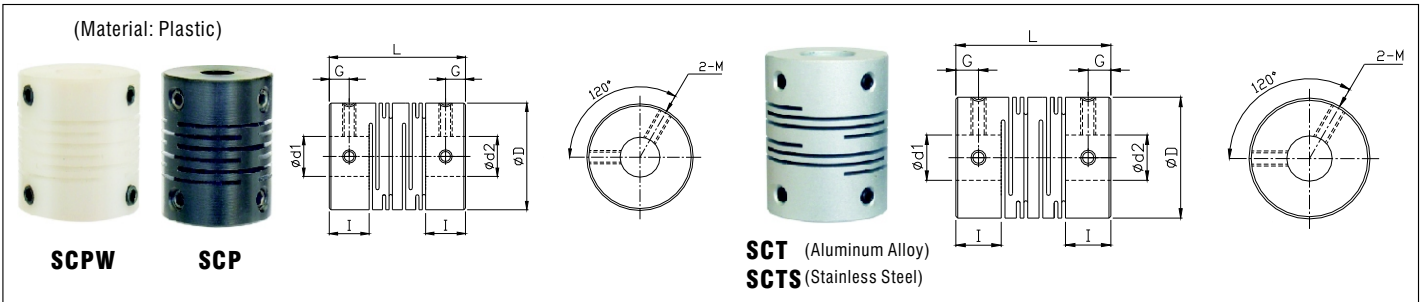

Model No.	Diameter(D)	Length (L)	G	M	d1xd2		Rated Torque (N.m)	Max. Torque (N.m)	Max. Rotational Frequency (min ⁻¹)	Errors of Eccentricity (mm)	Errors of Angularity (°)	Errors of Shaft End-play (mm)
					Min.	Max						
SCP-16/SCPW-16	16	23	3	M3	5	8	0.15	0.3	6000	0.2	2.5	±0.3
SCP-20/SCPW-20	20	26	3.5	M4	6	8	0.25	0.5	8000	0.2	2.5	±0.3
SCP-25/SCPW-25	25	31	4	M4	6	12	0.5	1.0	10000	0.2	2.5	±0.3
SCT-16	16	23	3	M3	4	8	0.3	0.3	24000	0.1	2	±0.4
SCT-20	20	26	3	M4	5	10	0.5	0.5	19000	0.1	2	±0.4
SCT-25	25	31	4	M4	5	12	1	1	15000	0.15	2	±0.5
SCTS-16	16	23	3	M3	4	8	0.5	0.5	24000	0.1	2	±0.3
SCTS-20	20	26	3	M3	5	10	1	1	19000	0.1	2	±0.3
SCTS-25	25	31	4	M4	6	12	2	2	15000	0.15	2	±0.4

■ **ORDERING INFORMATION**

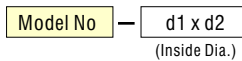

SCP-16-6x6

Wheel Type - Length Encoder



- High Response Frequency : 10K HZ
- High Speed Resolution : 6K RPM
- Voltage & Current Output with NPN + PNP Output
- High Reliability with Anti-Noise Circuit
- Multi-Measuring Unit / Pulse: 1.0mm, 0.01m, 0.1m, 1m, 0.001yd, 0.01yd, 0.1yd & 1yd
- Following models with Two Phase Output : WE-M2T, WE-M3T, WE-M4T, WE-Y2T, WE-Y3T, WE-Y4T

Type	Meter Wheel				Yard Wheel			
Model No.	WE-M1	WE-M2	WE-M3	WE-M4T	WE-Y1	WE-Y2	WE-Y3	WE-Y4
Unit / Pulse	1M	0.1M	0.01M	1.0MM	1yd	0.1yd	0.01yd	0.001yd
PPR	0.2PPR	2PPR	20PPR	200PPR	0.2PPR	2PPR	20PPR	200PPR
Output Phase	Single	Single or 2 phase available			Single	Single or 2 phase available		
Operating Voltage	10 ~ 30VDC							
Current Consumption	30 mA max.							
Output method	NPN + PNP							
Output Current	150mA max.							
Residual Voltage	0.1V max.							
Leadage Current	0.1mA max.							
Rprotection Method	Polarity Reversed & Over load Protection							
Connection Method	2M cable							
Response Frequency	2K Hz		10K Hz		2K Hz		10K Hz	
Max. RPM	6K RPM		3K RPM		6K RPM		3K RPM	
Insulation Resistance	Over 50MΩ/ 500Vdc							
Dielectric Strength	Over 2.5KV							